

**CITY OF BELVEDERE SPECIFICATIONS
FOR CONCRETE CURB,
GUTTER, SIDEWALK AND DRIVEWAY APPROACH CONSTRUCTION**

1. Subgrade shall be compacted to at least 95% relative compaction in the top 6 inches.
2. Where unsuitable subgrade material is encountered, the City's representative may require remedial work to be done, including, but not limited to, placing a layer of Class 2 aggregate under the concrete section.
3. Existing concrete shall be removed at expansion or weakened plane joints or at sawcuts.
4. Sawcuts must be at least 1-1/2 inches deep.
5. No utility boxes or poles will be permitted in the sidewalk area without the written approval of the City's representative.
6. All concrete finishes shall be broom finish and or other finish as approved by the City's representative.
7. Concrete shall be State Class B, 5 sack mix with $\frac{3}{4}$ inch maximum aggregate. Belvedere requires 2 pounds of Davis Superblack per cubic yard concrete. No additional color shall be added except as approved by the City's representative to match existing concrete.
8. Concrete shall have a slump of not more than 4 inches.
9. No admixtures shall be used without the permission of the City's representative.
10. No concrete shall be placed until the City's representative has inspected and approved forms and subgrade.

See Diagrams on next two pages.

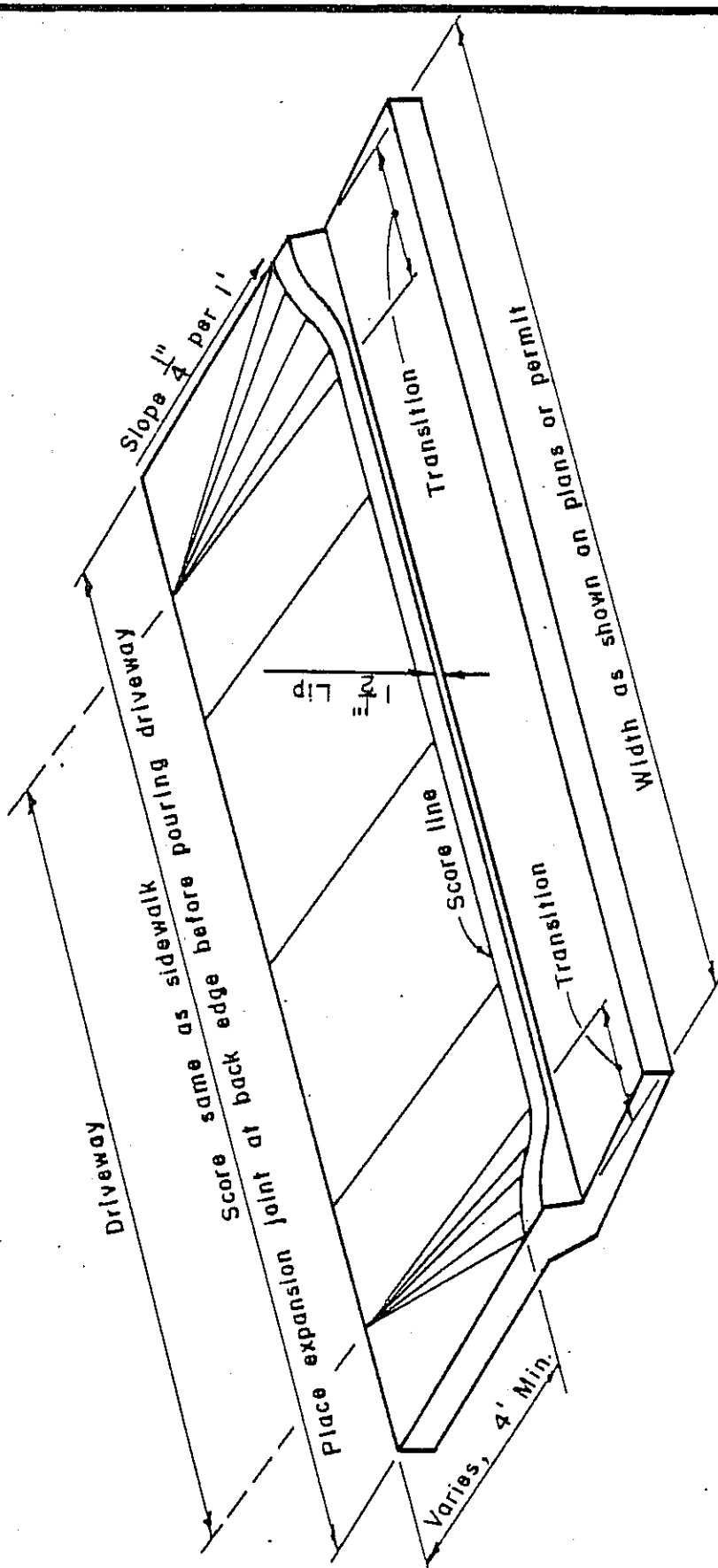

TYPE	THICKNESS	TRANSITION
Residential	6"	2'
Commercial	8"	4'

NOTE: See Drawing No. 100 for general notes.

UNIFORM STANDARDS
ALL CITIES AND
COUNTY OF MARIN

S T A N D A R D
DRIVEWAY
APPROACH

REV.	DATE	BY

DATE:
JUNE
1979
DWG. NO.
102

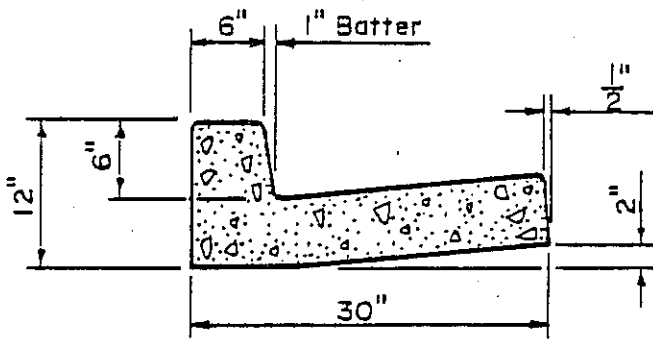

TYPE "A" CURB

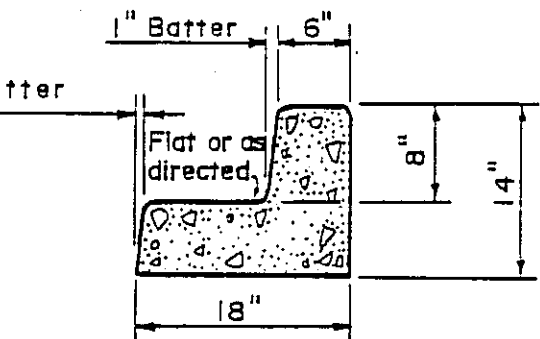

TYPE "B" CURB

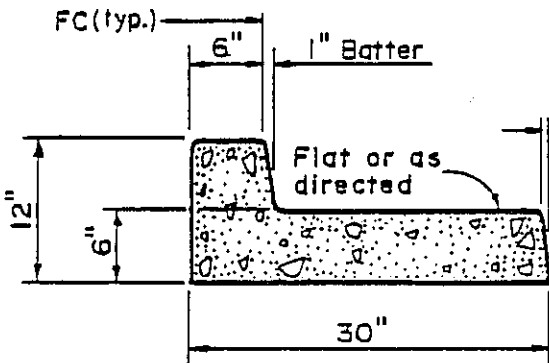

TYPE "C" CURB

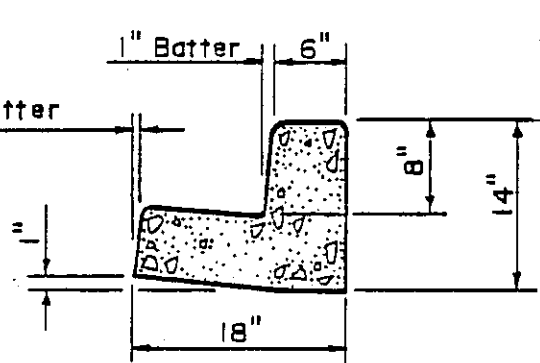

TYPE "D" CURB

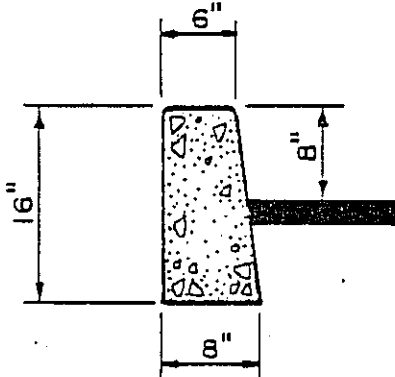

TYPE "E" CURB

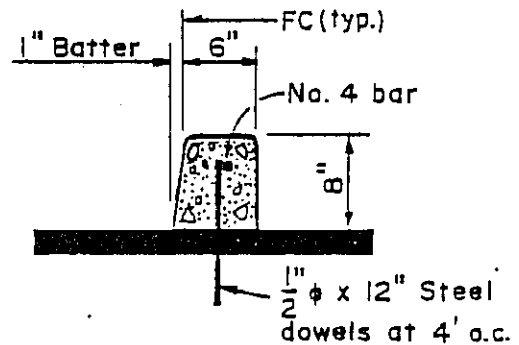

TYPE "F" CURB

NOT ACCEPTED BY COUNTY OF MARIN. REV. SEPARATE FROM CURB.

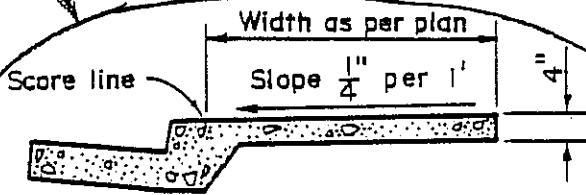

TYPE "A" SIDEWALK
POURED MONOLITHIC WITH CURB

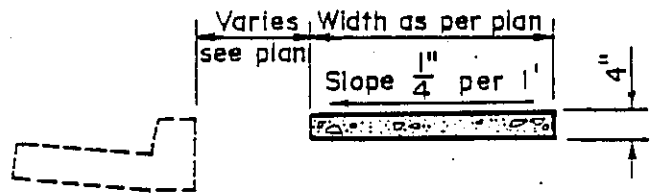

TYPE "B" SIDEWALK
POURED SEPARATE FROM CURB

NOTE: See Drawing No. 100 for general notes.

UNIFORM STANDARDS
ALL CITIES AND
COUNTY OF MARIN

STANDARD
CURB, GUTTER
AND SIDEWALK

REV.	DATE	BY

DATE:
JUNE
1979
DWG. NO.
101